

# Product Catalogue & Price List

October  
2023



Ventilation Manufacturers & Stockists  
Commercial & Domestic Sectors

[DUCTFIX.CO.UK](http://DUCTFIX.CO.UK)

# Our Service

## Together let's make duct WORK!

Here at DuctFix we have brought together quality ventilation products and combined them with the simplicity of online ordering which we are all used to in today's world. By embracing this technology DuctFix can provide the same quality products but with more cost effective service passing these savings onto you the customer.

Here are just some of the benefits of ordering via ductfix.co.uk.

- All products can be ordered on our user friendly website on desktop, tablet or smart phone.
- Account customers can order 24/7 and be invoiced monthly.
- Live stock levels showing instant availability.
- Use Ductfix.co.uk to cost projects quickly and efficiently then convert to an order at you leisure.
- Running totals calculated as you build your order.
- Allocation of your delivery when YOU want it.

This printed version of our catalogue serves as a quick guide for ease of reference or for when your internet connectivity is limited

Alongside our website we have a dedicated team of industry experienced sales personnel. For any technical information feel free to call us on 0121 559 1233 or email your enquiry to sales@ductfix.co.uk and one of our engineers will return your call.

## Contact

Issue: 2023/01A

All goods supplied subject to conditions of sale (see inside back cover)

**Birmingham & Head Office**  
125 Lodgefield Road, Halesowen  
West Midlands B62 8AX  
sales@ductfix.co.uk  
0121 559 1233

**Coventy**  
Unit 4 Bishopsgate Industrial Park  
Widdrington Road, Coventry CV1 4NA  
sales@ductfix.co.uk  
01179 822 722

**Bristol**  
4E Severnside Trading Estate  
Avonmouth BS11 9YQ  
sales@ductfix.co.uk  
01179 822 722



## In Stock



## Online



## On Time



### Ducter's Directory

Ducter's Directory is a facebook support group for UK ductwork installers nationwide to share information, work/labour availability, advise, photos etc...

Ducter's Directory



Contents

# Contents

1	Circular Duct and Fittings	4-7
2	Flexible Ducting	8
3	Support Systems	9-13
4	Fixing & Fastenings	14-15
5	Sealants, Gaskets, Tapes & Insulation	16
6	Access Doors	17
7	Fans & Equipment	18
8	Attenuators	19
9	Flashings	20

10	Dampers	21-23
11	Grilles & Diffusers	24
12	Louves & Plenum Boxes	25
13	Flanging System	26
14	Rectangular Ductwork	27-28
15	Plastic Ductwork	29
16	Tools, Consumables & PPE	30
17	Check List	31
18	Terms & Conditions	32

# Circular Duct & Bends



DIAMETER Ø	SPIRAL	Bend 90°	Bend 60°	Bend 45°	Bend 30°	Bend 15°	Full Radius B90
100	9.19	<i>3.05</i>	<i>4.01</i>	<i>2.45</i>	<i>3.10</i>	<i>4.34</i>	
125	11.30	<i>4.59</i>	<i>5.15</i>	<i>2.94</i>	<i>3.64</i>	<i>5.57</i>	
150	13.56	<i>5.72</i>	<i>8.07</i>	<i>3.80</i>	<i>5.20</i>	<i>6.20</i>	
160*	14.46	<i>6.46</i>	<i>8.90</i>	<i>5.69</i>	<i>7.19</i>	<i>6.53</i>	
180*	21.69	<i>9.22</i>	<i>8.90</i>	<i>5.69</i>	<i>7.19</i>	<i>6.53</i>	
200	21.69	<i>9.22</i>	<i>8.90</i>	<i>5.69</i>	<i>7.19</i>	<i>6.53</i>	
224*	27.12	13.81	10.10	10.41	9.11	<i>7.00</i>	
250	27.12	13.81	10.10	10.41	8.28	7.20	24.96
280*	32.55	14.64	11.22	9.51	7.79	7.80	28.97
300	32.55	14.64	11.22	9.51	7.79	7.80	39.36
315	34.18	15.92	12.14	10.25	8.36	8.36	42.78
355	51.35	19.56	14.76	12.36	9.96	9.96	56.20
400	57.87	24.09	18.00	14.96	11.94	11.94	65.44
450	65.10	29.68	21.96	18.11	14.25	14.25	79.80
500	72.33	35.83	26.31	21.54	16.79	16.79	100.90
560	81.01	49.46	36.03	29.31	22.59	22.59	139.30
600*	91.14	61.88	44.31	35.81	27.31	27.31	172.70
630	91.14	61.88	44.31	35.81	27.31	27.31	172.70
710	102.70	95.50	54.81	44.01	33.21	33.21	297.02
800	106.44	119.18	67.91	54.21	40.50	40.50	335.61
900	162.75	132.02	93.47	74.19	54.91	54.91	388.68
1000	180.83	160.97	113.38	89.58	65.77	65.77	515.11

## We Manufacture

- Spiral Tube
- Circular Fittings
- Rectangular Ductwork
- Plenum Boxes
- Attenuators
- Stainless Steel Ductwork



All spiral tubes come in standard 3 metre lengths. Non standard lengths are available on request and will be charged at the metre rate. \*Diameter 160, 180, 224, 280 and 600 only available to special order. All bends are fabricated apart from those in italic which are pressed.

# Circular Fittings



DIAMETER Ø	MALE COLLAR	FEMALE COLLAR	MALE CAP END	FEMALE CAP END	MESH CAP END	FLANGED SPIGOT IL	PRESSED SADDLE	FLAT SHOE	CURVED SHOE
100	1.93	1.93	1.48	1.48	2.00	1.40	2.92	8.94	9.10
125	2.06	2.06	1.93	1.93	2.35	1.55	3.47	10.23	10.57
150	2.06	2.06	2.15	2.15	2.65	1.94	5.23	11.04	12.07
160	2.06	2.06	2.15	2.15	3.76*	2.01	5.23	11.54	13.02
180	2.64	2.64	3.00	3.00	5.25*	2.36	6.92	13.29	15.59
200	2.64	2.64	3.00	3.00	2.95	2.36	6.92	13.29	15.59
224	2.78	2.78	4.21	4.21	7.37*	2.72	10.94	20.35	20.35
250	2.78	2.78	4.21	4.21	3.75	2.72	10.94	20.35	20.94
280	3.58	3.58	9.14	9.14	13.71*	3.62		27.19	28.63
300	3.58	3.58	9.14	9.14	4.65	3.62		27.19	28.63
315	3.58	3.58	9.41	9.41	5.25	3.83		29.32	31.52
355	4.98	4.98	10.58	10.58	6.70	4.41		33.78	41.87
400	5.11	5.11	12.27	12.27	8.85	5.16		41.59	53.16
450	6.85	6.85	29.61	29.61	10.10	7.77		58.92	63.63
500	6.85	6.85	33.06	33.06	11.00	9.17		61.47	77.96
560	8.02	8.02	34.72	34.72	52.14	10.46		92.58	92.89
600	9.54	9.54	40.54	40.54	60.82	12.04		102.20	97.80
630	9.54	9.54	40.54	40.54	60.82	12.04		102.20	97.80
710	17.20	17.20	44.71	44.71	67.07	15.34		118.10	108.47
800	18.28	18.28	52.68	52.68	79.03	19.19			
900	21.59	21.59	63.12	63.12	94.68	14.21			

All goods supplied subject to conditions of sale (see inside back cover)

# Circular Fittings



DIAMETER Ø	EQUAL T-PIECE	TWIN BEND 90	TWIN BEND 45	STANDARD COWL	JET COWL	HORIZONTAL COWL	SUSPENSION RINGS	SPLIT RINGS	Single Blade Damper
100mm	7.50	26.96	19.03	25.36	82.08	20.68	2.10	1.70	6.90
125mm	9.85	31.44	20.52	28.45	85.65	20.68	2.26	1.80	7.70
150mm	10.52	34.54	21.91	29.22	92.23	21.68	2.47	1.90	7.95
160mm	12.65	35.38	22.46	32.37	92.23	21.68	3.16	2.00	7.95*
180mm	19.71	56.56	33.74	32.37	125.36	29.93	3.16	2.10	8.90*
200mm	16.46	47.12	28.13	42.78	104.46	24.95	3.88	2.60	8.90
224mm	26.43	63.67	52.61	42.78	134.43	29.93	3.88	2.80	15.45*
250mm	22.62	53.05	43.84	54.20	112.06	24.95	4.27	3.00	10.44
280mm	36.66	101.06	61.33	62.92	182.92	39.02	4.27	3.20	13.44*
300mm	31.20	84.21	51.11	71.86	152.44	32.52	4.33	3.40	13.44
315mm	32.76	84.21	52.61	85.68	152.44	34.54	5.07	6.04	15.71
355mm	37.44	103.89	58.00	92.46	161.96	38.98	5.48	6.63	15.60
400mm	44.85	120.73	65.58	95.60	175.83	46.80		8.28	18.20*
450mm	53.82	146.00	60.81	110.34	238.49	56.16		8.96	23.10*
500mm	64.61	157.50	90.05	117.85	264.96	67.70		10.52	23.70*
560mm	73.25	202.33	93.02	153.01	296.77	80.86		12.32	
600mm	84.24	266.05	127.80	153.01	333.86	96.98		12.32	
630mm	84.24	221.71	106.50	208.53	376.27	96.98		17.24	
710mm	102.96	290.68		219.96	423.97	105.69		20.83	

All goods supplied subject to conditions of sale (see inside back cover)

# Reducers - Concentric (Eccentric +50%)



DIA Ø	100	125	150	160	180	200	224	250	280	300	315	355	400	450	500	560	600	630	710	800	900
125	1.88																				
150	2.26	2.26																			
160	2.19	2.19	3.74																		
180	4.59	4.59	4.41	4.41																	
200	3.25	3.25	3.25	2.96	3.59																
224	6.09	7.47	7.47	5.92	5.88	6.26															
250	6.09	6.22	6.84	3.94	5.14	3.94	6.58														
280	25.31	26.46	25.49	25.49	24.37	8.87	23.43	6.35													
300	26.79	26.79	23.73	23.73	22.93	8.87	23.84	6.35	23.84												
315	26.79	26.79	23.73	23.73	22.93	6.27	23.84	6.21	23.84	21.09											
355	28.74	27.10	26.42	26.42	31.03	25.85	29.83	24.85	26.26	21.89	21.89										
400	33.74	30.49	29.52	29.52	34.81	29.03	34.81	29.01	32.74	27.28	27.19	25.07									
450		34.41	33.31	33.31	39.20	34.81	38.50	32.07	35.50	29.58	29.58	27.10	26.19								
500		35.30	35.30	35.30	41.99	38.50	41.30	34.41	38.98	32.47	32.47	29.40	27.84	27.84							
560			47.24	47.24	55.31	41.30	55.31	41.86	50.23	41.86	41.86	40.39	39.96	39.96	39.63						
600			55.91	55.91	55.31	55.31	55.31	50.23	50.23	50.23	50.21	48.42	47.95	47.95	47.67	47.67					
630			50.80	50.80	60.47	50.40	60.47	46.19	55.41	46.18	46.18	44.68	44.35	44.35	44.35	44.35	53.22				
710										84.54	80.66	80.66	80.66	80.66	76.27	76.27	86.03	86.03			
800										84.54	85.26	80.66	80.66	80.66	76.27	76.27	86.03	86.03	86.03		
900													121.35	121.35	121.35	121.35	135.27	110.29	110.92	110.92	
1000															121.35	121.35	194.93	81.22	129.31	129.31	124.35

# Flexible Ducting



Non-insulated

Dia Ø	10m length
100	5.30
125	6.60
150	9.50
160	11.60
180	12.50
200	13.20
224	16.00
250	17.30
280	20.90
300	21.70
315	22.10
355	26.60
400	35.00
450	40.50
500	46.90
560	77.47
630*	86.07



Insulated

Dia Ø	10m length
100	22.00
125	27.30
150	32.00
160	33.50
180	39.80
200	41.20
224	49.80
250	52.70
280	61.60
300	64.70
315	65.00
355	77.70
400	92.50
450	106.20
500	121.50
560	159.33
630*	180.23



Acoustic

Dia Ø	10m length
100	25.30
125	31.40
150	36.80
160	38.25
180	45.70
200	47.40
224	57.30
250	60.60
280	70.85
300	74.75
315	74.65
355	89.35
400	106.40
450	123.05
500	140.30
560	229.48
630*	260.08



Combi

Dia Ø	6m length
100	7.30
125	9.20
150	11.20
160	13.90
180	14.90
200	16.30
224	21.50
250	21.50
280	27.40
300	27.40
315	28.00
355	32.20
400	38.00
450	50.60
500	50.60
560	89.01
630*	103.50



P.U.

Dia Ø	1m length
63	8.58
80	9.13
100	10.12
125	12.10
150	13.97
160	14.96
180	18.15
200	18.15
224	19.36
250	23.65
280	28.27
300	31.13



PVC Flex

Dia Ø	6m length
100	14.55
125	18.20
150	18.70
200	26.60
250	28.55
300	39.60
315	49.80
355	61.45
400	74.45



Alu Semi Rigid

Dia Ø	3m length
100	9.50
125	12.20
150	16.60
200	25.90
250	38.00
300	49.20
315	57.80

## Lightning Band System

Description	Price
30 Metre Coil	11.90
Locks/50 box	11.90



## Hose Clips

Dia Ø	Price Each
135mm	0.50
152mm	0.54
175mm	0.61
233mm	0.66
332mm	0.87
533mm	1.38

All goods supplied subject to conditions of sale (see inside back cover)



# Support Systems by

## Zip Clip Rize Clips



Description	Price/10
KL50 Zip-Clip Rize 0-10kg SWL	18.50
KL100 Zip-Clip Rize 10-75kg SWL	21.00
KL150 Zip-Clip Rize 75-120kg SWL	30.50
KL200 Zip-Clip Rize 120kg-230kg SWL	61.10

## Zip Clip Wire Rope



Description	Price/Roll
200m Zip-Clip KL50 Wire Rope (10kg SWL)	42.30
100m Zip-Clip KL100 Wire Rope (50kg SWL)	25.90
100m Zip-Clip KL150 Wire Rope (120kg SWL)	41.50
100m Zip-Clip KL200 Wire Rope (230kg SWL)	61.25

## Knock On Perlin Clips



Description	Price/Roll
1-5mm Perlin Clips 3mtr Wire	47.75
1-5mm Perlin Clips 5mtr Wire	52.00

## Wire Hanger



Description	Price/Roll
M6x63mm SRS Ceiling Fixing	13.50

## Zip Clip Loop-It Suspension



Description	Price / 10
1mtr Loop-It c/w KL50 (10kg SWL)	35.00
2mtr Loop-It c/w KL50 (10kg SWL)	37.00
3mtr Loop-It c/w KL50 (10kg SWL)	39.00
4mtr Loop-It c/w KL50 (10kg SWL)	41.00
5mtr Loop-It c/w KL50 (10kg SWL)	47.00
10mtr Loop-It c/w KL50 (10kg SWL)	69.00
1mtr Loop-It c/w KL100 (45kg SWL)	42.00
2mtr Loop-It c/w KL100 (45kg SWL)	45.00
3mtr Loop-It c/w KL100 (45kg SWL)	48.00
4mtr Loop-It c/w KL100 (45kg SWL)	50.00
5mtr Loop-It c/w KL100 (45kg SWL)	57.00
10mtr Loop-It c/w KL100 (45kg SWL)	84.00
1mtr Loop-It c/w KL150 (90kg SWL)	52.00
2mtr Loop-It c/w KL150 (90kg SWL)	57.00
3mtr Loop-It c/w KL150 (90kg SWL)	61.00
4mtr Loop-It c/w KL150 (90kg SWL)	65.00
5mtr Loop-It c/w KL150 (90kg SWL)	75.00
10mtr Loop-It c/w KL150 (90kg SWL)	114.00
1mtr Loop-It c/w KL200 (200kg SWL)	94.00
2mtr Loop-It c/w KL200 (200kg SWL)	104.00
3mtr Loop-It c/w KL200 (200kg SWL)	113.00
4mtr Loop-It c/w KL200 (200kg SWL)	123.00
5mtr Loop-It c/w KL200 (200kg SWL)	143.00
10mtr Loop-It c/w KL200 (200kg SWL)	229.00

## Strut Loop System



Description	Price/10
1 Mtr Strut Loop (45kg SWL)	58.50
2 Mtr Strut Loop (45kg SWL)	61.50
3 Mtr Strut Loop (45kg SWL)	64.00
4 Mtr Strut Loop (45kg SWL)	66.50
5 Mtr Strut Loop (45kg SWL)	69.50
10 Mtr Strut Loop (45kg SWL)	83.00

## Zip Clip Duct Lock



Description	Price/10
Zip Clip Duct Lock (45kg SWL)	59.00

## Zip Clip Uni Lock



Description	Price/10
3mtr Zip Clip Uni Lock (45kg SWL)	49.50

## Wire Accessories

Description	Price Each
Heavy Duty Wire Cutter	43.00
Tensioning Tool	160.00
Plastic Sleeving 100m x 3mm	58.00
Corner Saddles (Qty 10)	2.25

# Channel Support Systems

## Channel - Pre-galvanised



Size	Price	length
(Slotted) 41 x 21 x 1.6mm	8.75	3m
(Slotted) 41 x 41 x 1.6mm	9.90	3m
(Plain) 41 x 21 x 2.5mm	21.70	5m
(Plain) 41 x 21 x 2.5mm	10.85	3m
(Plain) 41 x 41 x 2.5mm	29.70	5m
(Plain) 41 x 41 x 2.5mm	14.85	3m
(Slotted) 41 x 21 x 2.5mm	21.70	5m
(Slotted) 41 x 21 x 2.5mm	10.90	3m
(Slotted) 41 x 41 x 2.5mm	29.65	5m
(Slotted) 41 x 41 x 2.5mm	14.85	3m
(Plain) 41 x 41 x 2.5mm x 2	33.86	3m

## Channel Slide Nuts



Description	Price/100
M6 (No spring)	7.70
M8 (No spring)	7.70
M10 (No spring)	9.65
M12 (No spring)	9.95
S-M6 (Short spring)	9.80
S-M8 (Short spring)	10.20
S-M10 (Short spring)	10.70
S-M12 (Short spring)	10.80

## Flexi Foot Strut Support



Description	Price/Roll
250mm	9.62
400mm	11.13
600mm	16.63
1000mm	34.12

## Foot Strut Channel Kit 110x110



Description	Price/Roll
250mm (2 Feet)	8.25
450mm (2 Feet)	10.32
650mm (3 Feet)	47.16

## H-Frame Foot Strut



Description	Price/Roll
305mm Foot 41x41 Kit Pair (Inc Nuts, Bolts & Cleats)	27.50
500mm Foot 41x41 (Individual)	77.00

## Slotted Punch Banding



Description	Price/100
25mm wide x 0.90mm thick x 25 metres	9.66

## Plate Washers 40x40x3mm



Size	Price/100
M6 Hole	20.50
M8 Hole	20.50
M10 Hole	20.50
M12 Hole	20.50

## Top Plates

Size	Price/100
M6 Hole	18.96
M8 Hole	18.96
M10 Hole	18.96
M12 Hole	18.96

## Studding



Threaded Rod	Price/3mtr
M6	1.55
M8	1.61
M10	2.29
M12	4.55

# Support Systems

## Support Channel Fittings & Brackets



Description	Price
DF00/M6 (Clearance hole for M6)	0.12
DF00/M8 (Clearance hole for M8)	0.12
DF00/M10 (Clearance hole for M10)	0.12
DF00/M12 (Clearance hole for M12)	0.12
DF01 Two Hole Channel Flat Plate	0.37
DF02 Three Hole Channel Flat Plate	0.49
DF03 Four Hole Channel Flat Plate	0.65
DF04 Five Hole Channel Flat Plate	0.67
DF06 90° Flat Plate	0.65
DF07 Flat Tee	0.70
DF11 1 x 1 Hole 90° Angle Cleat	0.34
DF12 2 x 1 Hole 90° Angle Cleat	0.63
DF14 2 x 2 Hole 90° Angle Cleat	0.75
DF15 2 x 2 Hole 90° Gusset Angle Cleat	1.68
DF22 21mm Step 'Z' Bracket	0.56
DF23 41mm Step 'Z' Bracket	0.92
DF24 82mm Step 'Z' Bracket	1.44
DF25 21mm Top Hat 'U' Bracket	0.90
DF26 41mm Top hat 'U' Bracket	0.95
DF29-30° Obtuse Angle 2 x 2 Hole	1.02
DF29-45° Obtuse Angle 2 x 2 Hole	1.02
DF29-60° Obtuse Angle 2 x 2 Hole	1.02
DF31-30° Acute Angle 1 x 1 Hole	1.32
DF31-45° Acute Angle 1 x 1 Hole	0.70
DF31-60° Acute Angle 1 x 1 Hole	1.32

Description	Price
DF33 41x41 Channel Coupler	4.14
DF37 Double Channel Base Plate	6.84
DF38 Double Fix Base Plate	2.22
DF44 Tapped Beam Clamp	1.92
DF45/82 82x21 Window Bracket	3.18
DF45/41 41x41 Window Bracket	1.44
DF45/21 41x21 Window Bracket	1.32
DF48 Top Beam Clamps	0.72
DF90/8 (Clearance hole for M6) Flange Clamp	1.50
DF90/8 (Clearance hole for M8) Flange Clamp	1.56
DF90/10 (Clearance hole for M10) Flange Clamp	1.62
DF90/12 (Clearance hole for M12) Flange Clamp	2.64
DF91 (Clearance hole for M10) Perlin Clamp / Clip	0.35
DF40/300 (Cantilever Arm-Universal)	4.05
DF40/450 (Cantilever Arm-Universal)	5.30
DF40/600 (Cantilever Arm-Universal)	6.25
DF40/900 (Cantilever Arm-Universal)	8.75
PVC Channel End Cap 41 x 21 White/Black	0.06
PVC Channel End Cap 41 x 41 White/Black	0.07

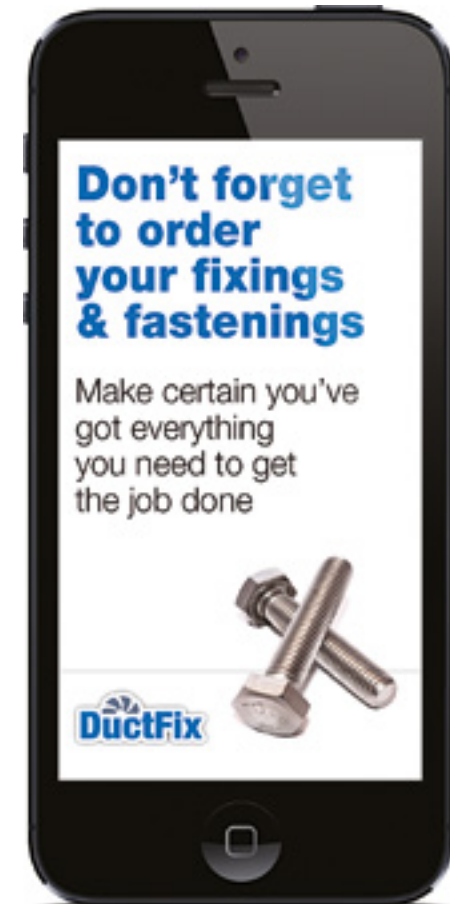

# Support Systems

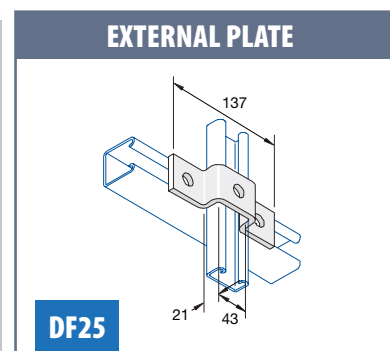
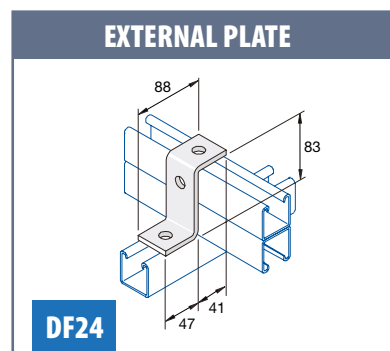
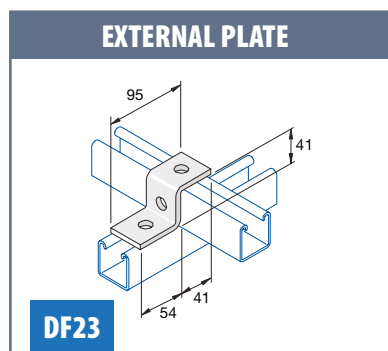
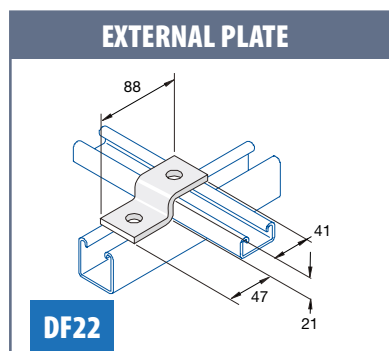
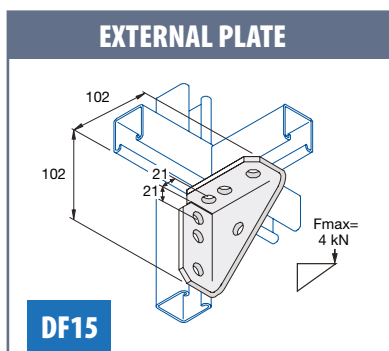
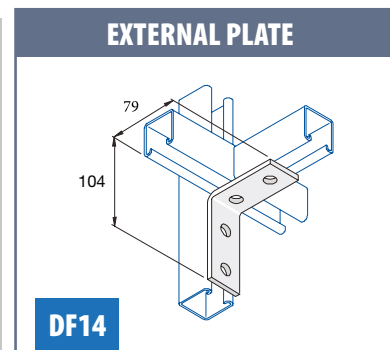
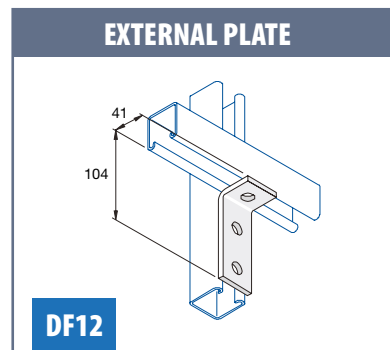
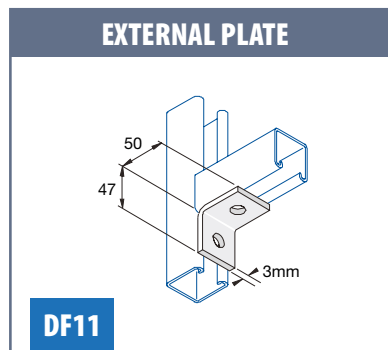
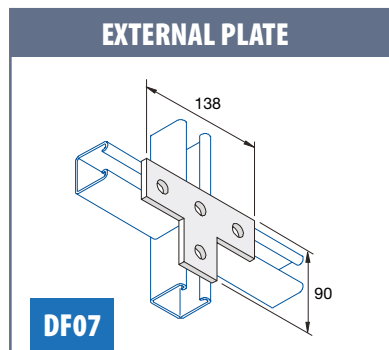
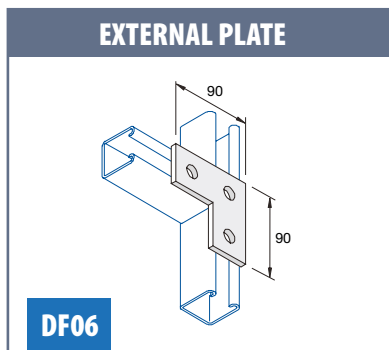
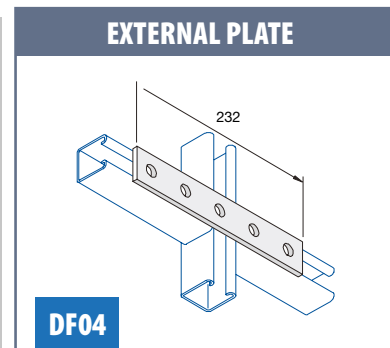
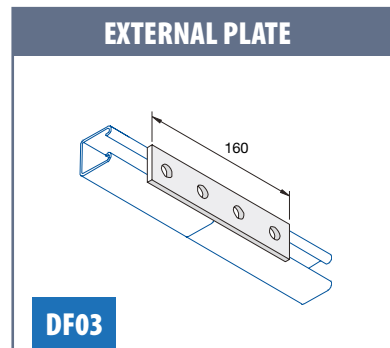
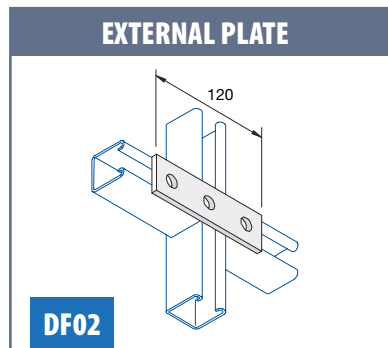
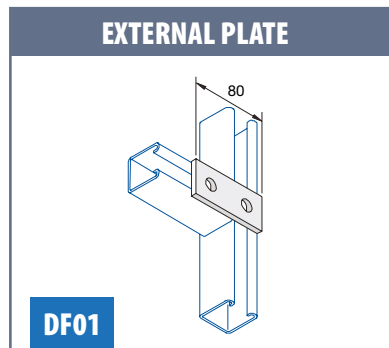
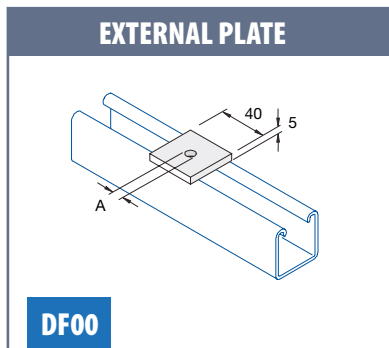

# Support Systems

<b>EXTERNAL PLATE</b>  <b>DF26</b>	<b>EXTERNAL PLATE</b>  <b>DF29</b>	<b>EXTERNAL PLATE</b>  <b>DF31</b>	<b>EXTERNAL PLATE</b>  <b>DF33</b>	<b>BASE PLATE</b>  <b>DF37</b>
<b>BASE PLATE</b>  <b>DF38</b>	<b>UNIVERSAL CANTILEVER ARM</b>  <b>DF40 /300 /450 /600</b>	<b>BEAM CLAMP</b>  <b>DF44</b>	<b>WINDOW BRACKET</b>  <b>DF45 /41 /21</b>	<b>BEAM CLAMP</b>  <b>DF48</b>
<b>BEAM CLAMP</b>  <b>DF90</b>	<b>PURLIN CLIP</b>  <b>DF91</b>	<b>THREADED ROD HANGER</b> 	<b>THREADED ROD HANGER</b> 	<b>PVC END CAPS</b> 

# Fixings & Fastenings

## Screws, Nuts, Bolts & Rivets

Hexagon Head Set Screws (8.8HT)	
Size	Price/100
M6 x 20. Zinc-plated	1.40
M6 x 25. Zinc-plated	1.75
M6 x 30. Zinc-plated	2.11
M6 x 35. Zinc-plated	3.71
M6 x 40. Zinc-plated	4.49
M8 x 20. Zinc-plated	3.01
M8x 25. Zinc-plated	4.20
M8 x 30. Zinc-plated	4.77
M8 x 35. Zinc-plated	5.07
M8 x 40. Zinc-plated	5.42
M10 x 20. Zinc-plated	6.24
M10 x 25. Zinc-plated	5.60
M10 x 30. Zinc-plated	6.31
M10 x 35. Zinc-plated	7.89
M10 x 40. Zinc-plated	8.22
M12 x 20. Zinc-plated	7.19
M12 x 25. Zinc-plated	7.35
M12 x 30. Zinc-plated	8.31
M12 x 35. Zinc-plated	10.64
M12 x 40. Zinc-plated	9.46

Hex Nuts	
Size	Price/100
M6 Zinc-plated	0.55
M8 Zinc-plated	1.43
M10 Zinc-plated	2.53
M12 Zinc-plated	3.06

### Roofing Nuts & Bolts

Size	Price/100
M6 x 20. Zinc-plated	25.20
M8x 20. Zinc-plated	28.80
M10 x 20. Zinc-plated	34.80

### Rivets

Size	Price
2 x 8 Box 1000	17.40
3.2 x 11 Box 1000	21.36
4.0 x 10 Bx 1000	22.44
4.0 x 13 Box 1000	27.60
4.8 x 10 Box 500	13.56
4.8 x 15 Box 500	17.40
4.8 x 18 Box 500	21.96
4.8 x 25 Box 500	37.20

Fully sealed aluminium rivets with steel mandrels	
Type	Price/1000
SA3210	28.56
SA4008	36.84
SA4010	42.12
SA4012	42.12
SA4810	44.88
SA4812	48.48
SA4814	50.64
SA4818	78.60

### All Steel Rivets

Size	Price/500
4.0 x 12	14.76
4.0 x 16	16.68
4.8 x 12	21.72
4.8 x 16	30.36

### Boss Plates

Size	Price/Each
M6 Female	0.72
M8 Female	0.84
M10 Female	0.96
M12 Female	1.08



# Fixings & Fastenings

## Screws, Nuts, Bolts & Rivets

Self-Drilling Screws (Tec Screws)	Price
Pro-Point type for fixing 1.0 - 1.6mm sheet.	
Size	Price/1000
CL-VRD 4.2x13	10.20
CL-VRD 4.2x19	12.50
CL-VRD 4.8x19	23.28

Coach Screws	Price
Size	Price/10
M6 x 30	2.34
M6 x 40	2.46
M6 x 50	2.88
M6 x 65	4.32
M6 x 75	8.04
M8 x 50	8.64
M8 x 75	6.72
M8 x 100	7.86
M8 x 120	8.28
M10 x 50	9.00
M10 x 75	12.48
M10 x 100	13.32
M10 x 130	14.76
M10 x 150	16.20

Penny Washers	Price
Size	Price/100
M6 x 25. o/d. Zinc-plated	1.43
M8 x 25. o/d. Zinc-plated	1.43
M10 x 25 o/d Zinc-plated	1.43
M12 x 25. o/d. Zinc-plated	1.66

Drop In / Non Drill Anchors	Price
Size	Price/100
M6	13.99
M8	17.03
M10	20.04
M12	22.66

Sleeve Anchors	Price
Size	Price/10
M8 x 60mm	5.93
M8 x 85mm	7.34
M8 x 110mm	6.29
M10 x 60mm	8.39
M10 x 85mm	10.14
M10 x 110mm	12.67
M12 x 60mm	13.78
M12 x 85mm	15.74
M12 x 110mm	17.01

All goods supplied subject to conditions of sale (see inside back cover)



# Sealants, Gaskets, Tapes & Insulation

## Tapes & Gaskets

Description	Price
Aluminium Foil Tape 50mm x 50m	3.50
Aluminium Foil Tape 75mm x 50m	5.20
Aluminium Foil Tape 100mm x 50m	7.00
PVC Duct Tape 50mm x 33mtr	4.38
Cloth Duct Tape 50mm x 50mtr	3.20
Self Adhesive Flange Gasket Tape 20mm x 6mm x 15mtr	3.10
Self Adhesive Flange Gasket Tape 25mm x 6mm x 15mtr	3.60
Arboseal Intumescent Fire Resistant Tape, 15mm x 3mm x 12M	10.56

## Insulation & Acoustic

Description	Price
Ductwrap 25mm x 1.2mtr x 18mtr	92.55
Ductwrap 50mm x 1.2mtr x 9mtr	94.00
6mm x 2mtr x 1mtr Self Adhesive Sheets	15.00
12mm x 2mtr x 1mtr Self Adhesive Sheets	22.91
25mm x 2mtr x 1mtr Self Adhesive Sheets	31.30
50mm x 2mtr x 1mtr Self Adhesive Sheets	61.80
Phenolic Strip Flat 25mm x 50mm x 1m (Box/36)	69.24
Phenolic Strip Flat 38mm x 50mm x 1m (Box/30)	78.24
Phenolic Strip Flexible 25mm x 50mm x 1m (Box/36)	126.36
Phenolic Strip Flexible 25mm x 50mm x 1m (Box/36)	122.52

## Sealants

Description	Price
Solvent Free Duct Seal 310ml	2.00
Rapid Cure Solvent Ductseal 380ml	4.68
Clear Silicone 310ml	4.74
Intumescent Sealant	4.74

## Ancillaries

Description	Price
Spray Can Adhesive	6.40
62mm Stick Pins & Hangers (per 100)	14.00
110mm Stick Pins & Hangers (per 100)	17.40
Triangle Ductwork Identification Labels (5 per sheet)	2.04

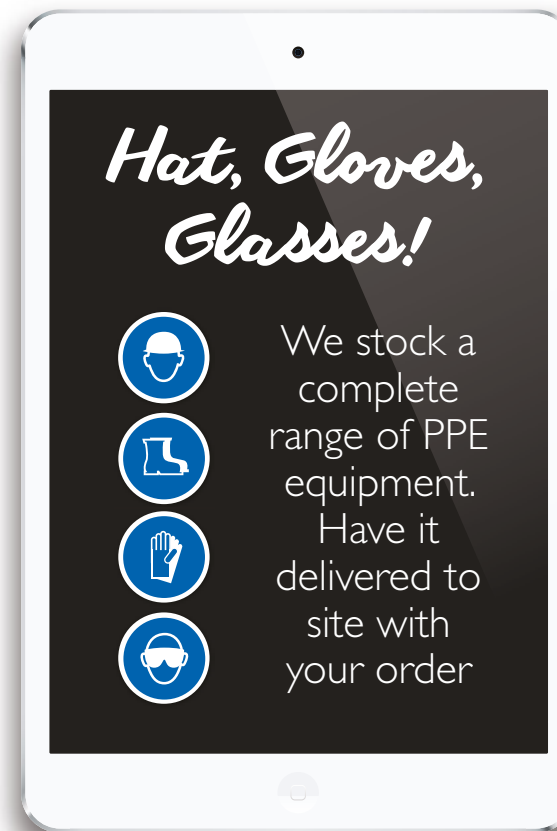



# Access Doors

## Tabbed Doors c/w Safety Wire



Door Size O/D	Price
100x100*	7.80
150x100*	7.80
150x150	7.80
200x200	9.80
250x250	11.30
300x150	10.90
300x200	14.70
300x300	13.40
350x350	16.30
400x200	14.40
400x300	18.40
400x400	17.90
450x300	18.40
450x450	21.70
500x500	24.70
600x300	19.20
600x400*	30.12
600x450*	31.12
600x600	30.80

## Access Door c/w Saddle

Door Size O/D	Price
100x100	21.62
150x100	22.00
150x150	22.50
200x200	26.75
250x250	23.00
300x150	30.63
300x200	31.25
300x300	32.87
350x350	40.25
400x200	36.37
400x300	40.25
400x400	41.12
450x300	41.37
450x450	43.37
500x500	51.50
600x300	67.25
600x400	67.88
600x450	70.12
600x600	72.00

## Curved Doors



Type	Description	Price
Type A (180x 80)	Duct Dia Range 100-125mm	3.10
Type B (250x150)	Duct Dia Range 150-500mm	5.45
Type C (300x200)	Duct Dia Range 560-800mm	8.45
Type D (400x300)	Duct Dia Range 560-800mm	11.40

## High Pressure Doors



Type	Description	Price
AP1	233 x 143	12.00
AP2	362 x 227	21.50
AP3	494 x 354	35.00
AP4	647 x 496	55.00

Additional latches and support chains available.  
Non standard sizes available on request

## Fire Rated Access Doors BS476 - 4 Hour



Door Size	Price
200x200	80.50
300x300	87.50
350x350	98.00
400x400	110.00
450x450	121.00

## Curved Door Safety Edging

Size	Price
7x5mm x 1mtr	2.43

# Fans & Equipment

## Inline Tube Fans



DIAMETER Ø	PRICE
100mm	95.55
125mm	101.23
150mm	108.06
200mm	131.95
250mm	180.86
315mm	233.18

## Short Cased Axials 4 Pole/1Ph



DIAMETER Ø	PRICE
250	428.84
315	510.74
355	528.94
400	614.25
450	766.68
500	861.09

## Twin Impeller Axials 4 Pole/1Ph



DIAMETER Ø	PRICE
450	1225.00
500	1351.35
560	154.86
630	1867.78

## Ancillary Packs

Inc AVs, Rings, Feet & Flexes



DIAMETER Ø	PRICE
400	210.60
450	230.78
500	279.05
560	315.05
630	323.79

## Plate Fans

4 Pole/1 Ph



DIAMETER Ø	PRICE
250	239.55
315	249.21
400	318.55
450	361.53
500	430.85
630	749.38

## Long Cased Axials 4 Pole/1Ph



DIAMETER Ø	PRICE
400	806.49
450	883.84
500	952.09
560	1127.26
630	1194.38

## Electric Heater Batteries



DIAMETER Ø	kW	Phase	PRICE
100	0.6	1	159.73
125	1.2	1	197.42
150	2.7	1	239.68
200	3.0	1	273.94
250	3.0	1	291.08
315	3.0	1	302.50
315	4.5	1	433.48
315	9.0	3	433.84
355	9.0	3	502.38
400	9.0	3	502.38
400	12.0	3	536.64

- Kitchen canopy Systems
  - Air Conditioning Units
  - Cooling Towers
  - Sports Halls
  - Factories
  - Warehousing
  - Agriculture
  - Schools
  - Hotels
- Unsure which fan you require...?  
Let DuctFix select a fan appropriate for your system

# Attenuators



DuctFix not only stock a large range of circular attenuators but alongside **AVE-NTA** Acoustics design and manufacture rectangular and circular attenuators for all sectors of the industry to the specific requirements of Acoustical Consultants, Consulting Engineers and Ventilation Contractors.

## Circular Spigotted Attenuators



Dia Ø	300L	600L	900L	1200L
100	29.00	35.00	42.00	67.00
125	31.00	38.00	47.00	72.00
150	33.00	42.00	53.00	81.00
200	40.00	50.00	62.00	102.00
250	46.00	57.00	76.00	132.00
315	60.00	71.00	92.00	138.00
355	70.00	91.00	104.00	159.00
400	83.00	111.00	125.00	183.00
450	94.00	133.00	143.00	201.00
500	109.00	152.00	162.00	224.00
560	125.00	162.00	176.00	263.00
630	143.00	198.00	228.00	301.00

## Circular Flanged Attenuators



Dia Ø	1D	2D	1D Podded	2D Podded
355	163.75	197.50	240.00	296.25
400	202.50	245.00	266.25	368.75
450	208.75	252.00	308.75	388.75
500	235.00	327.50	352.50	468.75
560	265.00	427.50	397.50	592.50
630	308.75	502.50	445.00	668.75
710	350.00	541.25	601.25	922.50
800	432.25	775.00	657.50	1,173.75
900	631.25	970.00	922.50	1,415.00
1000	683.75	1,203.75	1,010.00	1,706.25

## Matching Flange Rings



Dia Ø	Price Each
355	41.24
400	41.24
450	42.99
500	62.30
560	71.95
630	74.58
710	81.60
800	92.13
900	102.66
1000	112.32

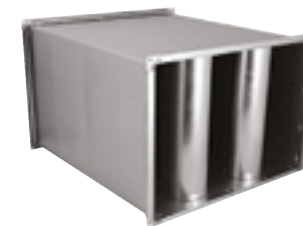

Prices for rectangular attenuators available on request. Call 0121 559 1233

# Flashing Systems

## Masterflash - EDPM

BLACK -50°C - 115°C



Pipe Ø	Price
76-152	15.90
102-178	19.60
127-228	23.60
152-280	47.50
178-330	52.50
254-467	76.80
330-660	218.00

## Masterflash - Silicone

RED -74°C - 260°C



Pipe Ø	Price
76-152	25.60
102-178	34.50
127-228	39.40
152-280	79.40
178-330	88.55
254-467	121.00
330-660	381.50

## Strip Flashings



Size	Type	Price
100mm x 10mtr	Flash Banding Roll	10.80
150mm x 10mtr	Flash Banding Roll	13.92
225mm x 10mtr	Flash Banding Roll	21.72
150mm x 5mtr	Aluflash Flashing Roll	47.28
250mm x 5mtr	Aluflash Flashing Roll	75.72
300mm x 5mtr	Aluflash Flashing Roll	92.88

## Circular Pitched Roof Plates

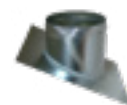

Pipe Ø	Price
355	36.60
400	44.16
450	53.52
500	63.60
560	86.52
630	104.52
710	119.28

## Storm Collars



Pipe Ø	Price
100	19.20
125	22.68
150	23.04
200	24.48
250	26.88
300	27.72
315	28.20
355	29.76
400	33.72
450	40.56
500	44.40
560	47.04
630	87.24
710	95.64

## Fixing Kits

Type	Price
SK1	8.78
SK2	21.14

# Dampers - Volume Control



## Additional Pricing

Multiple units (max width 2000mm).....	x1.2
Stainless Steel Blades.....	x1.2
Aluminium Blades.....	x1.2
Extended Spindle Kit.....	12.00
Conversion Kit Bare Shaft to Handle .....	12.00

mm	100	150	200	250	300	350	400	450	500	550	600	650	700	750	800	850	900	950	1000
100	30.40	31.43	32.47	32.99	34.88	36.25	37.28	37.51	38.99	40.55	41.35	42.77	43.97	45.17	46.03	46.90	48.11	49.30	50.17
150	35.04	35.91	36.58	37.97	38.83	39.51	40.20	42.26	42.95	43.33	44.84	46.38	47.59	48.44	49.65	50.52	51.88	52.57	53.76
200	38.71	39.33	39.68	41.74	42.26	42.95	44.84	45.52	46.21	47.06	48.78	50.00	51.35	52.06	53.60	54.46	55.32	56.51	57.38
250	41.74	42.09	42.95	43.63	45.88	46.72	48.11	48.78	49.61	51.54	52.40	53.08	54.64	55.65	57.04	57.91	58.93	59.96	61.15
300	45.44	46.38	48.44	48.78	49.47	49.81	50.52	53.08	54.46	55.32	56.00	57.21	58.76	59.96	60.64	61.50	62.88	63.91	65.10
350	53.76	49.47	51.35	52.06	53.08	54.97	55.65	56.70	57.73	59.27	60.64	62.02	62.88	63.91	65.10	65.96	67.18	68.20	69.41
400	53.76	55.16	55.65	56.70	57.38	58.40	59.61	60.99	62.20	63.74	64.59	65.63	66.83	68.20	69.06	70.08	71.47	76.67	74.05
450	59.10	59.96	60.64	61.50	63.22	64.09	64.49	64.95	65.63	67.69	68.90	69.41	71.47	72.49	73.70	75.24	76.63	77.83	78.86
500	61.34	62.02	62.69	63.39	65.10	67.00	67.69	69.92	71.47	72.84	74.22	75.42	76.63	78.00	79.04	80.75	82.46	83.50	85.04
550	64.95	65.79	66.83	67.51	68.54	71.30	72.84	73.70	75.42	76.29	78.34	79.99	80.92	82.64	84.00	85.56	87.26	88.64	89.85
600	69.41	70.08	72.07	72.14	72.84	75.59	76.63	78.68	80.06	81.60	82.97	84.00	86.08	87.97	89.51	90.87	92.42	93.80	95.69
650	74.73	75.59	75.63	77.83	78.52	79.71	80.75	81.94	83.83	85.56	87.10	89.33	92.09	93.46	95.01	96.90	98.44	99.42	101.54
700	79.04	80.06	80.40	82.13	83.33	84.00	85.38	87.45	89.67	91.05	93.96	94.67	97.06	97.92	100.33	102.41	102.90	106.17	108.40
750	81.42	82.46	83.16	84.00	86.08	87.87	90.02	91.74	93.96	95.85	97.92	99.82	101.17	104.29	105.65	107.56	109.79	111.67	112.69
800	85.04	85.91	86.93	87.79	89.17	90.17	92.95	96.55	98.96	101.71	103.42	105.49	107.89	110.30	112.19	114.24	118.90	119.24	120.26
850	89.67	90.87	92.09	93.28	94.49	95.36	99.47	100.85	104.29	107.19	109.27	111.50	112.69	115.62	117.69	119.74	123.01	125.07	127.12
900	93.80	95.85	97.92	98.09	99.31	100.33	104.29	105.30	109.45	111.33	113.74	117.51	118.84	120.61	123.20	125.16	128.30	130.17	132.81
950	99.31	100.96	101.71	103.25	104.63	105.30	108.75	110.64	114.24	116.83	119.74	121.13	124.03	125.42	128.15	129.54	134.00	136.24	138.99
1000	103.95	104.97	107.19	108.58	110.81	113.74	115.79	118.37	120.61	123.53	125.76	128.92	130.58	132.97	135.71	137.97	140.53	143.10	144.83

# Dampers - Circular VCD & Fire

## Circular Multi Dampers



Dia Ø	PRICE
100	33.56
125	38.99
150	38.99
200	42.19
224	48.63
250	48.63
300	55.03
315	59.55
355	59.55
400	64.24
450	70.15
500	77.42
560	94.83
600	102.06
630	109.79

## Circular Fire Dampers



Dia Ø	PRICE
100	60.34
125	61.79
150	61.79
200	63.41
224	67.22
250	67.22
300	69.87
315	78.67
355	78.67
400	82.44
450	88.00
500	99.33
560	108.84
600	121.95
630	130.22
710	142.97

## Single Blade Dampers



Dia Ø	PRICE
100	6.90
125	7.70
150	7.95
160	7.95*
180	8.90*
200	8.90
224	15.45*
250	10.44
280	13.44*
300	13.44
315	15.71
355	15.60
400	18.20*
450	23.10*
500	23.70*

## Blast Gate Dampers



Dia Ø	PRICE
63	16.38
80	16.66
100	20.30
125	25.62
150	31.08
160	39.62
180	43.96
200	52.36
224	62.16
250	77.42
300	104.30
315	160.58
355	200.76
400	299.60

## Back Draft Dampers



Dia Ø	PRICE
100	2.30
125	2.50
150	3.00
160	4.20
200	6.20
250	8.30
315	15.20
400	29.80

## Single Blade Fire Dampers



Dia Ø	PRICE
100	59.67
125	61.84
150	66.60
160	69.23
200	75.37
250	88.55
300	96.42
315	102.62

## Additional Information

For additional information and data sheets for any of the above products please visit [www.ductfix.co.uk/datasheets](http://www.ductfix.co.uk/datasheets)

# Dampers - Fire



Rectangular fire dampers  
manufactured from corrosion  
resistant galvanised steel, with  
blades outside airstream.  
Rectangular spigot, high velocity.

## Additional Pricing

Replacement Flat Bar Fusible Link 72°C .....	2.75
Easy Maintenance Link 72°C.....	4.13
Mechanical Visual Position Indicator.....	5.50
For Grade 430 Stainless Steel Blades & Casing .....	x 2
Pull Rings .....	0.34

mm	100	150	200	250	300	350	400	450	500	550	600	650	700	750	800	850	900	950	1000
100	54.51	54.51	54.51	57.84	57.84	57.84	62.84	71.18	71.18	72.86	72.86	76.20	76.20	87.87	87.87	89.55	89.55	96.21	97.88
150	54.51	56.19	56.19	62.84	62.84	62.84	67.76	72.86	72.86	72.86	76.20	79.53	79.53	89.55	89.55	89.55	91.21	96.21	97.88
200	51.19	52.98	53.34	56.26	58.55	60.34	62.33	64.29	66.09	69.52	72.56	75.08	77.04	79.76	82.08	86.03	91.42	93.94	97.17
250	52.27	53.16	54.42	57.66	59.80	62.50	64.29	66.81	68.78	71.12	74.72	76.88	79.03	80.83	84.95	88.00	92.65	95.01	98.25
300	53.69	54.42	56.03	60.18	62.86	65.02	68.42	70.40	72.91	77.40	79.21	82.26	84.06	87.64	91.07	93.58	96.26	99.14	101.30
350	54.42	55.68	56.95	62.50	65.38	68.42	70.77	73.10	76.69	78.67	82.44	87.48	89.80	93.58	96.26	98.98	101.66	105.25	108.12
400	55.68	57.30	57.66	64.67	67.63	70.22	72.74	79.92	83.35	86.03	89.27	91.61	94.47	98.25	101.30	104.70	106.86	110.45	113.33
450	59.62	60.17	64.29	59.34	72.56	77.40	80.11	84.06	86.75	88.38	91.23	97.89	101.12	105.08	107.77	110.45	112.97	116.93	121.43
500	62.06	66.28	68.06	72.74	76.52	80.11	83.70	86.75	89.44	94.30	98.43	100.59	103.28	107.22	109.37	114.77	119.43	125.37	131.47
550	66.09	70.22	72.38	75.79	79.92	82.44	86.03	88.90	93.22	96.62	100.21	102.38	105.25	108.66	114.05	120.61	125.19	131.30	134.35
600	74.14	72.19	75.97	79.03	81.72	84.06	87.48	90.71	95.37	99.14	103.09	106.86	108.12	113.69	118.36	126.44	130.58	136.14	143.14
650	84.66	76.52	79.76	81.72	84.06	86.75	89.99	93.75	98.06	100.59	105.45	109.37	113.17	119.08	125.92	128.79	135.61	142.62	146.02
700	76.15	79.76	82.99	78.76	86.93	89.44	90.71	97.17	100.05	103.09	107.57	112.44	117.47	123.92	128.42	135.26	140.82	144.41	149.61
750	79.03	82.64	86.58	89.27	91.42	94.11	96.46	99.50	102.92	109.73	111.90	116.20	122.85	128.24	134.35	137.94	143.50	148.73	155.20
800	80.47	84.60	88.19	91.23	93.75	96.46	98.43	101.86	105.61	107.77	110.13	120.68	125.73	131.66	136.69	142.78	147.82	152.86	159.49
850	83.16	86.93	90.87	93.58	96.41	98.60	101.86	107.78	109.93	114.23	119.81	123.56	130.93	138.85	146.93	150.15	155.55	157.87	163.45
900	85.67	89.99	93.75	96.26	98.06	101.12	103.84	109.02	112.61	119.43	124.48	129.67	135.42	143.87	149.08	153.57	158.77	162.36	166.68
950	89.44	92.49	95.37	97.53	100.77	102.57	105.78	112.08	117.11	125.92	128.24	133.99	141.01	148.54	153.22	155.73	162.36	166.32	170.44
1000	91.78	95.01	97.53	99.69	102.38	104.89	108.49	114.42	121.24	129.15	133.10	139.02	145.85	152.86	155.55	160.40	166.51	170.27	174.76

# Grilles & Diffusers



## 4 Way Diffuser (CD) Aluminium RAL9010

Face Size	Nominal Size	With Damper	W/O Damper
300mm x 300mm	150mm x 150mm	18.60	15.80
375mm x 375mm	225mm x 225mm	24.10	17.00
450mm x 450mm	300mm x 300mm	32.50	18.90
595mm x 595mm	450mm x 450mm	45.60	24.50

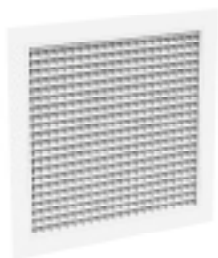

## Egg Crate Grille Aluminium RAL9010

Face Size	Nominal Size	Price
145mm x 145mm	100mm x 100mm	7.40
195mm x 195mm	150mm x 150mm	10.80
445mm x 445mm	400mm x 400mm	26.10
595mm x 595mm	550mm x 550mm	27.30



## Swirl Diffuser Aluminium RAL9010

Face Size	Nominal Size	Price
595mm x 595mm	254Ø	42.75
595mm x 595mm	336Ø	42.75
595mm x 595mm	440Ø	42.75
595mm x 595mm	530Ø	42.75

Supply

Extract

Metal Air Valves



Ø Dia	
100	2.50
125	3.70
150	4.90
200	7.80

Drum Jet Diffusers

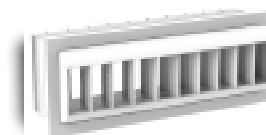

Jet Flow Diffusers   Spiral Duct Grilles

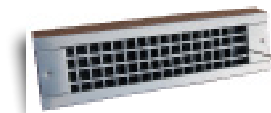

Bar Grilles



Swirl Diffusers



Cone Diffusers



Floor Grilles



Linear Slot Diffusers



All other grilles, diffusers and louvres available. Price on request.



# Louvres & Plenum Boxes

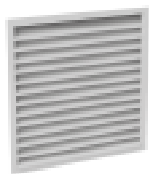

## Aluminium Louvres Mill Finish

Dimensions	Price Each
150 x 150	13.60
200 x 200	15.60
250 x 250	18.60
300 x 300	19.80
350 x 350	24.00
400 x 400	26.60
450 x 450	38.20
500 x 500	44.70
600 x 600	52.50



## Circular Weather Louvres

Dimensions	Price Each
100	2.90
125	3.60
150	5.60
200	8.30
250	14.90
315	25.80

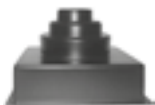

Dimension	Each
450x450 Multi Spigot Plastic Grille Box 150/200/250	15.75

+ 10% ADDITION FOR SHEET METAL FLANGE  
ALL OTHER SIZES AVAILABLE ON REQUEST

## Grille/Louvre Boxes

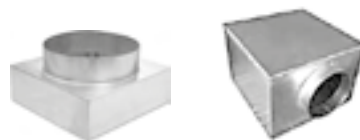

Dimensions	TOP ENTRY	SIDE ENTRY
100x100	17.65	18.07
125x125	17.81	18.40
150x150	18.07	18.90
200x200	18.33	20.09
225x225	18.59	21.55
250x250	18.82	22.30
300x300	19.34	25.27
350x350	19.89	25.84
400x400	20.51	29.95
450x450	23.73	36.52
500x500	26.20	41.52
550x550	27.02	46.07
600x600	28.13	50.41

Larger sizes and variations available on request

## Fan Coil Unit / Bespoke Plenums

We manufacture all types of plenums to suit all types of grilles, louvres and fan units from fully lined to liner bar grilles. Prices available on request



## Filter Boxes



Spigot Ø	Price Each
100	42.50
125	42.50
150	42.50
200	48.50
250	53.00
315	61.00
355	83.50
400	91.00
450	106.00
500	124.00
560	132.00

Larger sizes available on request

# Premium Flange System

Flange	5mtr	Corners	Box
20mm	10.30	20mm Short (500)	135.00
30mm	12.70	20mm Long (500)	163.00
40mm	23.50	30mm Short (250)	130.00
		40mm Short (150)	218.00

Description	Each
Turning Vane 3mtr	9.46
Mounting Track 3mtr	8.99
30mm Stiffening Bar x 5m	20.55
Bolt on Flange Clamps (100)	15.00



## Excel Flange – XL90S

Premium quality EXCEL Flange XL90S is a pocket flange which comes with integral high velocity duct sealant.



### Go Green

Air leakage is a major factor in wasted energy. Developed to reduce leakage, our slide on flange contains a permanently elastic heat resistant seal between sheet metal ductwork and the flanging system.



### Strength Through Design

Together with our customers and leading companies in the ventilation industry the EXCEL Flanging System stands out for its rigidity and performance in the manufacturing and assembly of ductwork and other ventilation components.



### The Answer

Developed to produce an air tight seal with ease of assembly and combined with superior rigor is what makes the EXCEL slide on flange the choice of the quality ductwork fabricator.

# Rectangular Ductwork Prices

All Low Velocity. Lengths of set, reducers and square to rounds are based on the longest side (600mm Max)



Duct Size	Straight @ 1500	B90	B45	Reducer	Set	Tee	Square - Round	Flat Shoe	Spigot	Cap End
100x100	33.00	19.00	14.00	20.00	21.00	30.00	20.00	17.00	16.00	13.00
150x150	40.00	24.00	17.00	23.00	25.00	36.00	22.00	19.00	18.00	14.00
200x200	48.00	30.00	21.00	27.00	28.00	43.00	24.00	21.00	20.00	16.00
250x250	55.00	37.00	26.00	30.00	33.00	50.00	27.00	23.00	21.00	18.00
300x300	62.00	44.00	31.00	35.00	37.00	58.00	30.00	25.00	23.00	19.00
350x350	69.00	52.00	42.00	39.00	43.00	67.00	33.00	27.00	25.00	21.00
400x400	76.00	61.00	43.00	44.00	48.00	76.00	37.00	29.00	26.00	23.00
450x450	83.00	71.00	52.00	49.00	54.00	87.00	41.00	31.00	28.00	25.00
500x500	89.00	81.00	57.00	54.00	61.00	97.00	45.00	33.00	30.00	27.00
550x550	98.00	92.00	65.00	60.00	67.00	109.00	49.00	35.00	31.00	29.00
600x600	105.00	104.00	73.00	70.00	66.00	121.00	54.00	37.00	33.00	31.00
650x650	112.00	117.00	82.00	72.00	83.00	134.00	60.00	39.00	34.00	33.00
700x700	119.00	131.00	92.00	79.00	91.00	147.00	65.00	41.00	36.00	36.00
750x750	126.00	145.00	102.00	86.00	99.00	162.00	71.00	43.00	38.00	38.00
800x800	133.00	162.00	113.00	93.00	108.00	176.00	77.00	45.00	39.00	41.00
850x850	140.00	173.00	121.00	101.00	118.00	192.00	83.00	47.00	41.00	43.00
900x900	148.00	194.00	136.00	109.00	128.00	208.00	90.00	48.00	43.00	46.00
950x950	155.00	211.00	148.00	117.00	138.00	225.00	97.00	50.00	44.00	49.00
1000x1000	162.00	229.00	161.00	126.00	149.00	243.00	105.00	52.00	46.00	51.00

# Rectangular Ductwork Quick Guide

Use this rectangular ductwork quickguide below or with a smartphone to relay site measures accurately.

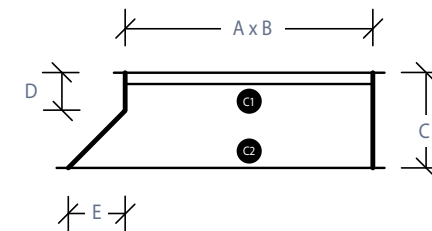
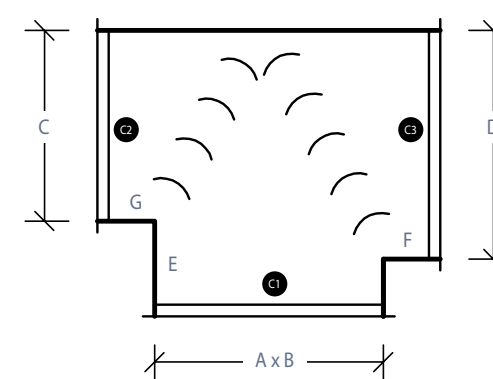
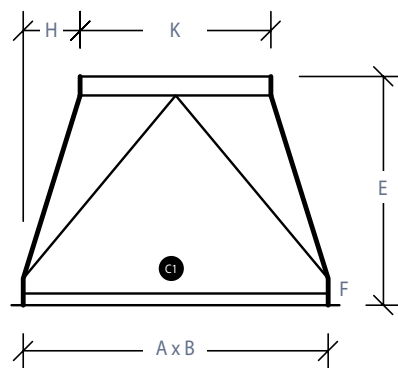
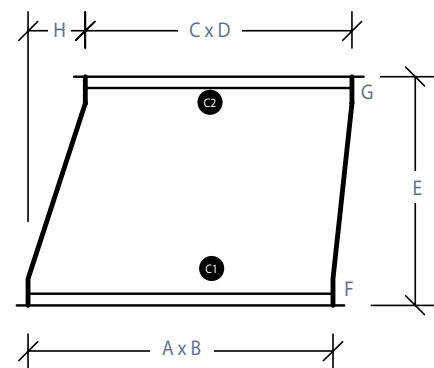
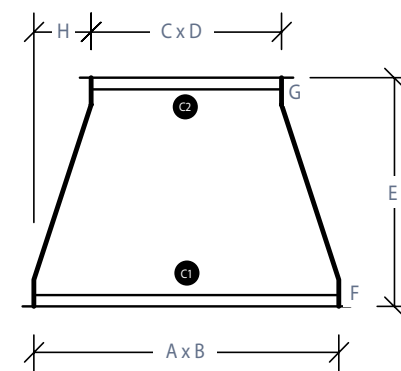
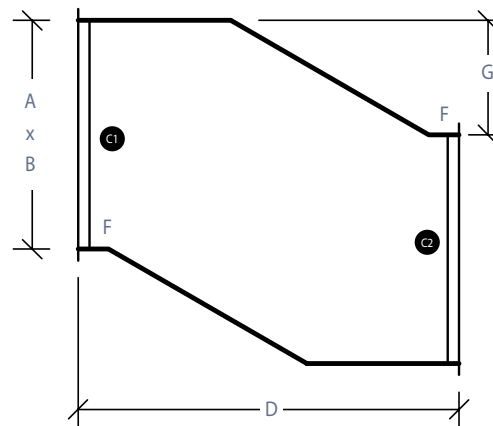
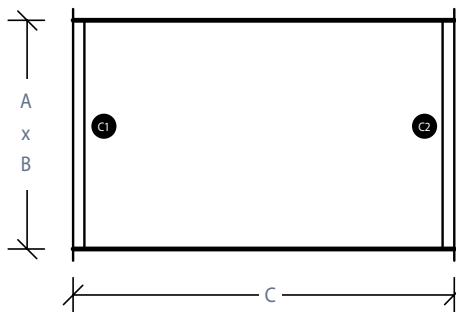
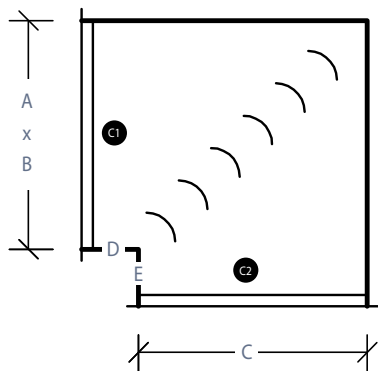

Dimension A = Top Depth  
Dimension B = Depth  
Dimension C = Bottom Width  
Dimension D = Top Extension

Dimension E = Bottom Extension  
Flange Type C1  
Flange Type C2  
FT = Flat Top

FB = Flat Bottom  
I = Setting Up/Down/On Top  
K = Circular Diameter

NB: When setting in two directions use an arrow to denote direction of set along with setting distance. Noting dimension taken from either top or bottom i.e. setting down 150mm on top.

Ducter's Directory



Rectangular Ducting

# Plastic Ductwork



Flat Channel	Each
110 x 54mm x 1m	2.70
110 x 54mm x 1.5m	4.10
110 x 54mm x 2m	6.10
150 x 70mm x 1m	4.20
150 x 70mm x 1.5m	6.30
150 x 70mm x 300mm	1.40
150 x 70mm x 400mm	1.60
204 x 60mm x 1m	5.00
204 x 60mm x 1.5m	7.50
204 x 60mm x 2m	9.55
220 x 90mm x 1m	6.20
220 x 90mm x 1.5m	9.40
220 x 90mm x 2m	12.50
225 x 25mm x 1m	9.30
225 x 25mm x 1.5m	13.90
225 x 25mm x 2m	18.50
225 x 25mm x 2.4m	22.20
300 x 25mm x 1m	11.70
300 x 25mm x 1.5m	17.60
300 x 25mm x 2m	23.40
300 x 25mm x 2.4	28.10

Horizontal T-Piece	Each
110 x 54mm	1.50
204 x 60mm	4.00
220 x 90mm	4.80

Horizontal B90	Each
110 x 54mm	1.00
150 x 70mm	2.80
204 x 60mm	3.40
220 x 90mm	4.50
225 x 25mm	3.10
300 x 25mm	4.30

Horizontal B45	Each
110 x 54mm	0.80
204 x 60mm	2.60
220 x 90mm	3.10
225 x 25mm	2.70
300 x 25mm	3.60

Elbow 90° M to F	Each
110 x 54mm - 100Ø	1.30
150 x 70mm - 125Ø	2.70
204 x 60mm - 100Ø	3.20
204 x 60mm 125Ø	3.20
204 x 60mm 150Ø	3.20
220 x 90mm - 100Ø	3.90
220 x 90mm 125Ø	3.90
220 x 90mm x 150Ø	3.90

Short Sq-Rd Adaptor	Each
110 x 54mm x 100Ø (F)	1.20
110 x 54mm x 100Ø (M)	1.20

Vertical B90	Each
110 x 54mm	0.90
150 x 70mm	2.10
204 x 60mm	2.40
220 x 90mm	3.00
225 x 25mm	2.70
300 x 25mm	3.20

Vertical B45	Each
110 x 54mm	3.30
204 x 60mm	3.40
220 x 90mm	4.00
225 x 25mm	6.70
300 x 25mm	7.50

Flat Channel Connector	Each
110 x 54mm	0.70
150 x 70mm	1.00
204 x 60mm	1.20
220 x 90mm	1.40
225 x 25mm	0.70
300 x 25mm	0.80

Sq-Rd Adaptor	Each
110 x 54mm x 100Ø	1.60
150 x 70mm x 125Ø	3.10
204 x 60mm x 100Ø	3.30
204 x 60mm x 125Ø	3.70
220 x 90mm x 150Ø	4.50

We Also Supply...

- Airbricks
- Louvres
- Wall Plates
- Circular Duct
- Insulated Duct
- Reducers
- Dampers
- Vent Kits
- Diffusers
- Cows

# Tools

## Hand Tools

DESCRIPTION	PRICE
13mm Chrome Vanadium Ratchet Spanner	6.00
17mm Chrome Vanadium Ratchet Spanner	11.00
13mm 1/2 Drive Long Socket	2.50
17mm 1/2 Drive Long Socket	3.00
Claw Hammer	7.00
8mtr Heavy Duty Tape Measure	4.50
Stanley Knife	4.50
Lazy Tong Riveter	15.00
Hand Riveter	9.00
Podger Dual Head 17mm & 21mm	9.50

## Power Tools

DESCRIPTION	PRICE
4.5inch Angle Grinder 110v	25.00
9inch Angle Grinder 110v	60.00

## 110v Accessories

DESCRIPTION	PRICE
110v 14mtr Lead	20.00
110v 25mtr Twin Socket Reel	45.00
110v Four Way Splitter 5mtr Lead	25.00
110v Three Way Splitter	15.00
110v Lead Light with Grip	15.00

# Consumables

## Abrasives

DESCRIPTION	PRICE
4.5 Inch Metal Cutting Disc 20pk	12.00
9 Inch Metal Cutting Disc 10pk	12.00
Hack Saw Blades 10pk	4.50

## Drill Bits

DESCRIPTION	PRICE
4.1mm HSS Stub 10pk	7.50
4.9 HSS Stub 10pk	10.00
6mm SDS Masonary Drill Bit	2.90
8mm SDS Masonary Drill Bit	3.25
10mm SDS Masonary Drill Bit	4.50
12mm SDS Masonary Drill Bit	5.80

## Misc

DESCRIPTION	PRICE
Tarpaulin 4.5 x 6.0 metres	11.00
Tarpaulin 9.0 x 14.0 metres	30.00
LED Head Torch	3.50
Heavy Duty Tool Bag	15.00
Sealer Gun	2.50
Heavy Duty Sealer Gun	4.50

# PPE

## Safety Wear

DESCRIPTION	PRICE
Hard Hat Yellow/White	4.50
Hi-Visibility Vest	5.00
Palm Coated Safety Gloves - Pair	1.50
Ear Defenders (over ear)	4.00
Safety Glasses	2.50
Premium Safety Goggles	4.00
Safety Boots	POA



# Fixings Check List



Use this handy checklist to ensure you have what you need to install your ductwork.

Description	QTY	Description	QTY
M6 x 20mm Set Pins		3.2 x 11mm Alu Rivets	
M6 x 25mm Set Pins		4.0 x 13mm Alu Rivets	
M6 x 30mm Set Pins		4.8 x 15mm Alu Rivets	
M6 x 40mm Set Pins		4.8 x 25mm Alu Rivets	
M8 x 20mm Set Pins		4.0 x 13mm Steel Rivets	
M8 x 25mm Set Pins		4.8 x 15mm Steel Rivets	
M8 x 30mm Set Pins		4.8 x 25mm Steel Rivets	
M8 x 40mm Set Pins		4.2 x 13mm Tek Screws	
M10 x 20mm Set Pins		4.2 x 19mm Tek Screws	
M10 x 25mm Set Pins		M6 x 40mm Coach Screws	
M10 x 30mm Set Pins		M8 x 40mm Coach Screws	
M10 x 40mm Set Pins		M8 x 75mm Coach Screws	
M12 x 20mm Set Pins		M6 Non Drill Anchors	
M12 x 25mm Set Pins		M8 Non Drill Anchors	
M12 x 30mm Set Pins		M10 Non Drill Anchors	
M12 x 40mm Set Pins		M12 Non Drill Anchors	
M6 Full Nuts		M6 Wire Hangers	
M8 Full Nuts		M8 Wedge Nuts	
M10 Full Nuts		M10 Wedge Nuts	
M12 Full Nuts		M12 Wedge Nuts	
M6 Penny Washers		M6 Stud Connectors	
M8 Penny Washers		M8 Stud Connectors	
M10 Penny Washers		M10 Stud Connectors	
M12 Penny Washers		M12 Stud Connectors	

Description	QTY
M6 Studding	
M8 Studding	
M10 Studding	
M12 Studding	
41x21mm x 3mtr LG	
41x21mm x 5mtr LG	
41x41mm x 3mtr LG	
41x41mm x 5mtr LG	
41x21mm x 3mtr HG	
41x21mm x 5mtr HG	
41x41mm x 3mtr HG	
41x41mm x 5mtr HG	
41x41mm x 3mtr HG x 2	
M6 Channel Nuts	
M8 Channel Nuts	
M10 Channel Nuts	
M12 Channel Nuts	
M6 Sq Plate Washers	
M8 Sq Plate Washers	
M10 Sq Plate Washers	
M12 Sq Plate Washers	
M20 x 5mtr Flange	
M30 x 5mtr Flange	
M40 x 5mtr Flange	
M20 Corner	
M30 Corner	
M40 Corner	
Bolt On Cleats	

Description	QTY
Zip Clip Type 50	
Zip Clip Type 100	
Zip Clip Type 150	
Zip Clip Type 200	
Type 50 Wire (200m)	
Type 100 Wire (100m)	
Type 150 Wire (100m)	
Type 200 Wire (100m)	
Duct Lock Zip Clips	
Zip Clip Loop It	
Zip Perlin Clips 3/5mtr	
Zip Wire Sleaving	
Zip Corner Saddles	
Zip Wire Cutters	
Perlin Clips M8/10/12	
Beam Clamps M8/10/12	
41x21 Window Brackets	
41x41 Window Brackets	
41x41 Angle Cleats	
82x41 Angle Cleats	
41x41 Base Plates	
Cantiliver Arms 300mm	
Cantiliver Arms 450mm	
Cantiliver Arms 600mm	
Stud Caps M6/8/10/12	
41x21 PVC End Caps	
41x41 PVC End Caps	
Punch Band 30mtr	

Description	QTY
Flexi Foot 250/400/600	
Strut Foot 350/500	
Phenolic Strip Flat	
Phenolic Strip Flexible	
Duct Seal Water Based	
Duct Seal Solvent	
Intumescent Seal	
Clear Silicone	
Grey Silicone	
PVC Duct Tape 50mm	
Cloth Duct Tape 50mm	
Alu Tape 50/75/100mm	
Flange Rubber 20x6mm	
Flange Rubber 25x6mm	
Butyl Tape 19/25x3mm	
Intumescent Tape	
Lightning Band	
L/Band Clips (50)	
Cable Ties 0.5/1mtr	
Ductwrap 25mm	
Ductwrap 50mm	
Self Adhesive Barafoam	
Spray Can Adhesive	
Galvafoam Spray	
Stick Pins	
Indentification Lables	
Tarpaulin Sheets	
Polythene Bags	





## 32